



Huskie TOOLS

EP-610H

15 Ton Remote Compression C-Head-2" Jaw Opening

www.huskietools.com

HuskieToolFacts

Specifications

Output	15 Ton
Weight	14.5 lbs.
Size	14.5" L
Jaw Opening	2"

Connector Range

Aluminum	#8 AWG - 1250 MCM
Copper	#8 AWG - 1500 MCM

Optional Accessories

PU-15 "U" Die Adapter

Features

- 3/8" Male Screw Type Coupler Provided
- Protective Rubber Boot on "C" Head

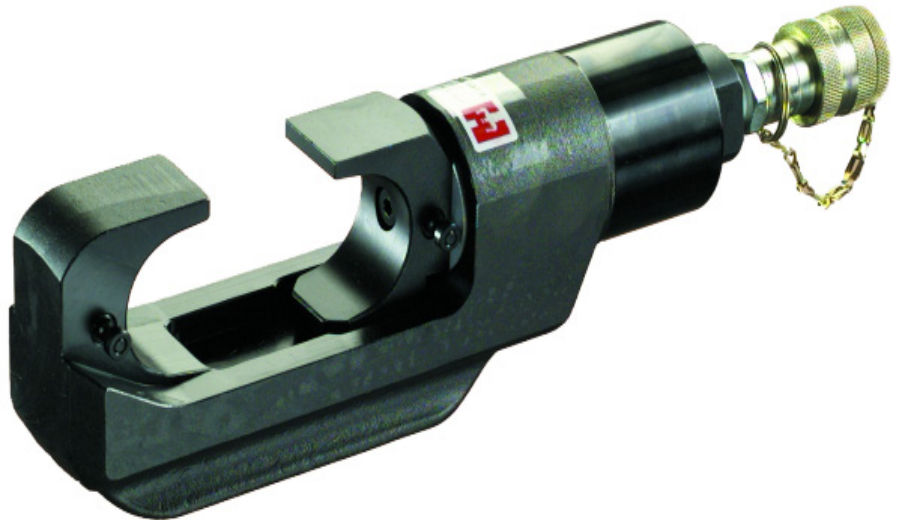

The **EP-610H** is a remote C-head that requires an external 10,000 psi pumping source. It accepts all Huskie HT61 series and Burndy "P" type dies used in the Y-46. When used with a Huskie PU-15 die adapter it will accept all "U" type dies used with any 12 ton tool. This tool is primarily used for cables above 750 MCM or in cases where additional tonnage is required to compress larger lugs, terminals and sleeves on tension connections. It is most always used on larger underground cables up to 1000 MCM. The EP-610H is supplied with a 3/8" male, screw type coupler and carrying case.

NOTE: When using any of these high-pressure tools, always use 10,000 psi rated non-conductive hose (NC-16 series).

www.huskietools.com 800-860-6170